



# Capital University

RESIDENTIAL AND COMMUTER LIFE

## Cotterman Hall

\*\*Please note that these floor plans are for reference only. These do not indicate what will be available at time of housing selection, and occupancy may be subject to change. Space coloration should be ignored.\*\*

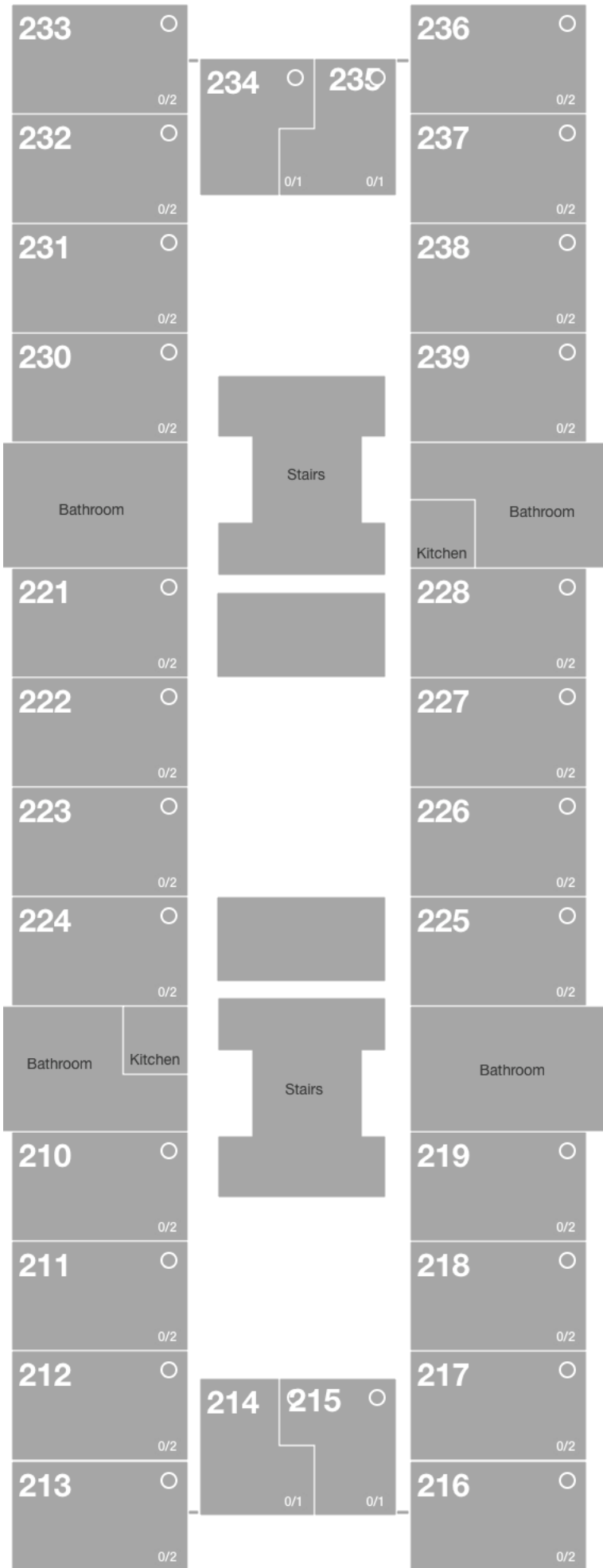

# Capital University

RESIDENTIAL AND COMMUTER LIFE

## Cotterman Hall

\*\*Please note that these floor plans are for reference only. These do not indicate what will be available at time of housing selection, and occupancy may be subject to change. Space coloration should be ignored.\*\*

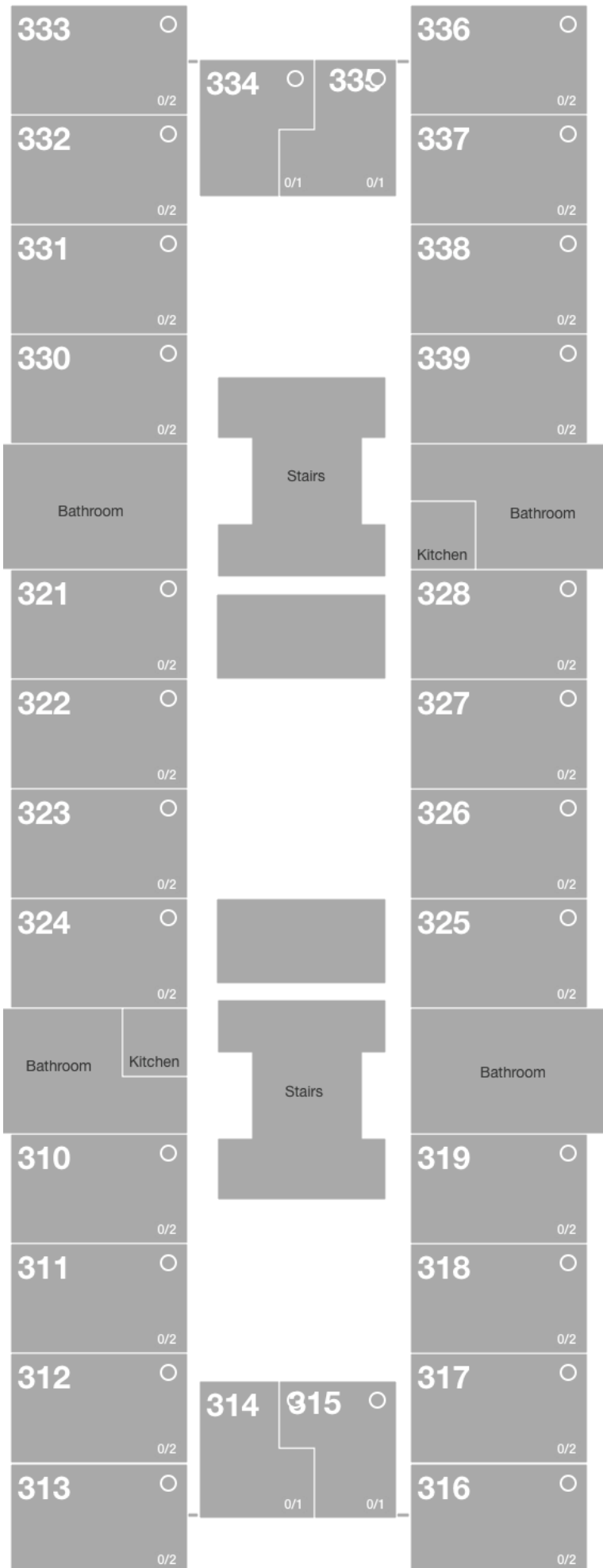

# Capital University

RESIDENTIAL AND COMMUTER LIFE

## Cotterman Hall

\*\*Please note that these floor plans are for reference only. These do not indicate what will be available at time of housing selection, and occupancy may be subject to change. Space coloration should be ignored.\*\*